

The Mashpee

The Avalon Collection

Engineered homes built magnificently, promptly, affordably.

Cape Style Plan

3 Bedrooms / 2 Baths

27'-6" x 48'-0"

First Floor Square Footage: 1286 s. f.

Second Floor: 744 s. f.

To Be Finished Onsite

Total Square Footage: 2030 square feet



The Cape Mashpee is a traditional cape plan which offers a large Living room area as well as a den. The plan also offers a first floor bedroom and the suggested second level offers two additional bedrooms and a bathroom.



1st Floor

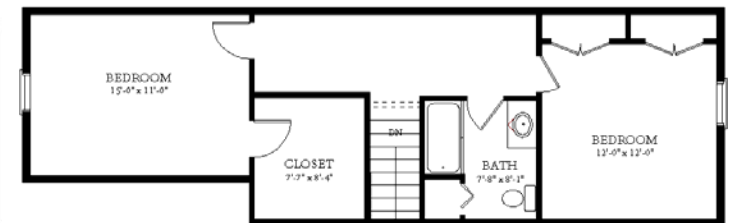

Proposed 2nd Floor
(To be Finished Onsite)



3 Porter Street, Suit 201
Stoughton, Ma 02072
Phone: 781-344-4875
Fax: 781-341-8321

Info@avalonbuildingsystems.com
www.avalonbuildingsystems.com